

NOTES:

THE COPYRIGHT OF THIS DRAWING IS VESTED IN THE ARCHITECT AND MUST NOT BE COPIED OR REPRODUCED WITHOUT HIS WRITTEN CONSENT. DO NOT SCALE THIS DRAWING - USE FIGURED DIMENSIONS ONLY. ALL CONTRACTORS MUST VISIT THE SITE AND BE RESPONSIBLE FOR TAKING OR CHECKING ALL DIMENSIONS REQUIRED FOR THIS WORK.

REVISIONS

A 17.12.23 - Prelim Issue

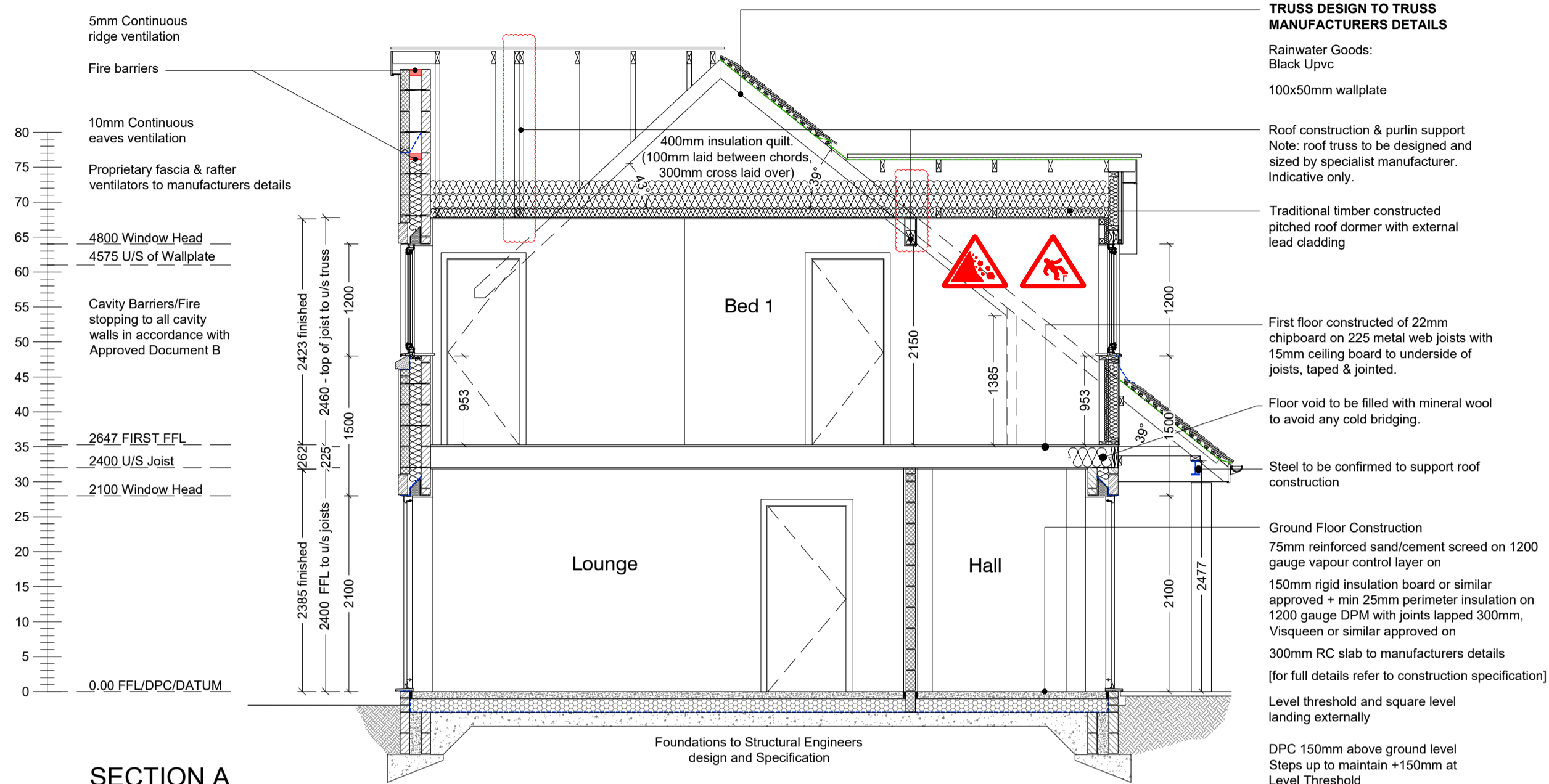

SECTION A

REFERENCE SHOULD BE MADE TO SOILS INVESTIGATION REPORT AND ENGINEERING DETAILS FOR THE SITE AND PLOT SPECIFIC PROPOSALS DEPENDANT ON GROUND CONDITIONS AND THE STRUCTURAL ENGINEER'S REQUIREMENTS. WHERE GROUND CONDITIONS ALLOW PROVIDE GROUND BEARING SLAB, WHERE GROUND CONDITIONS DO NOT ALLOW FOR GROUND BEARING SLABS THEN A PRE-CAST SUSPENDED CONSTRUCTION SHALL BE USED REFER TO SITE CONSTRUCTION SPECIFICATION.

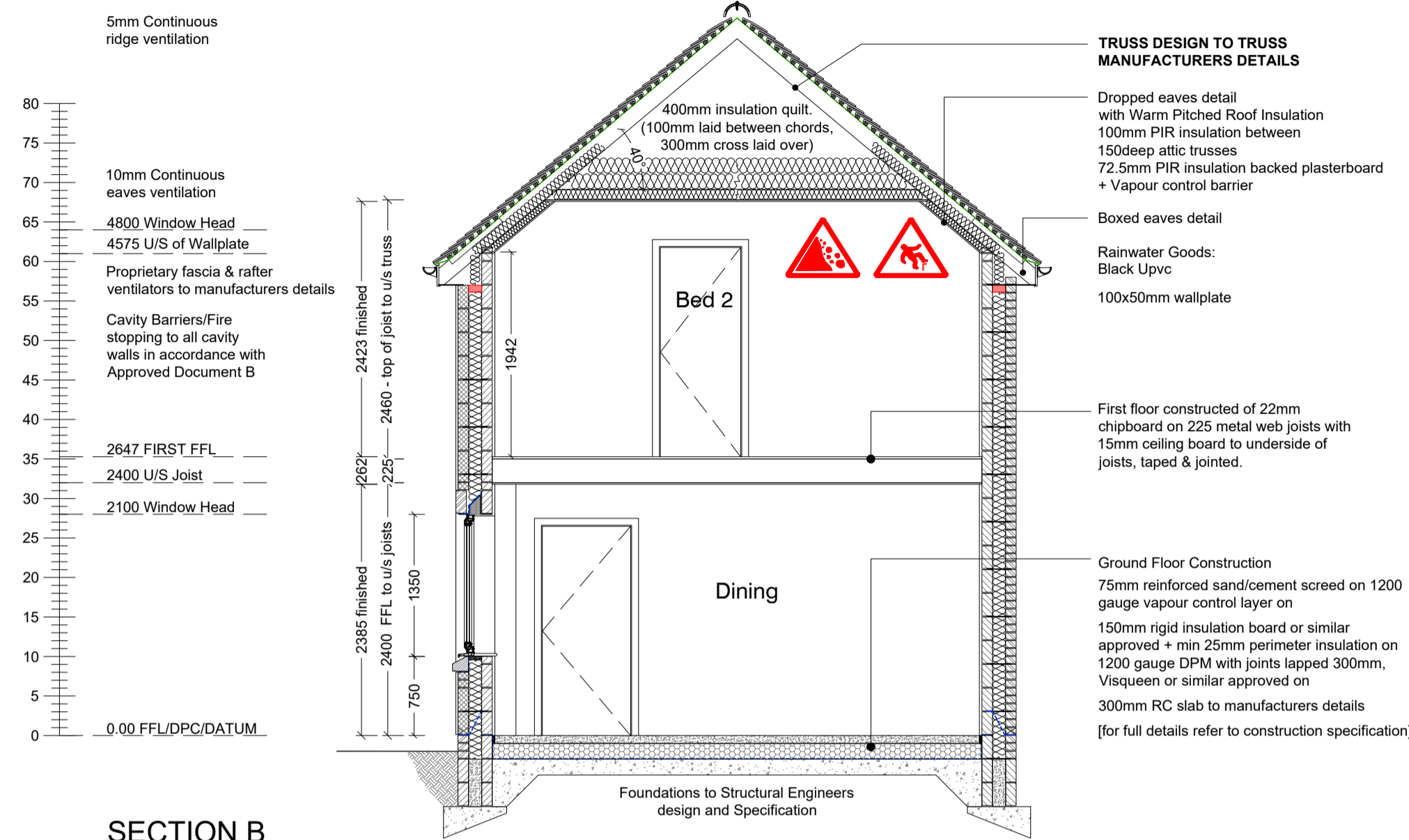

SECTION B

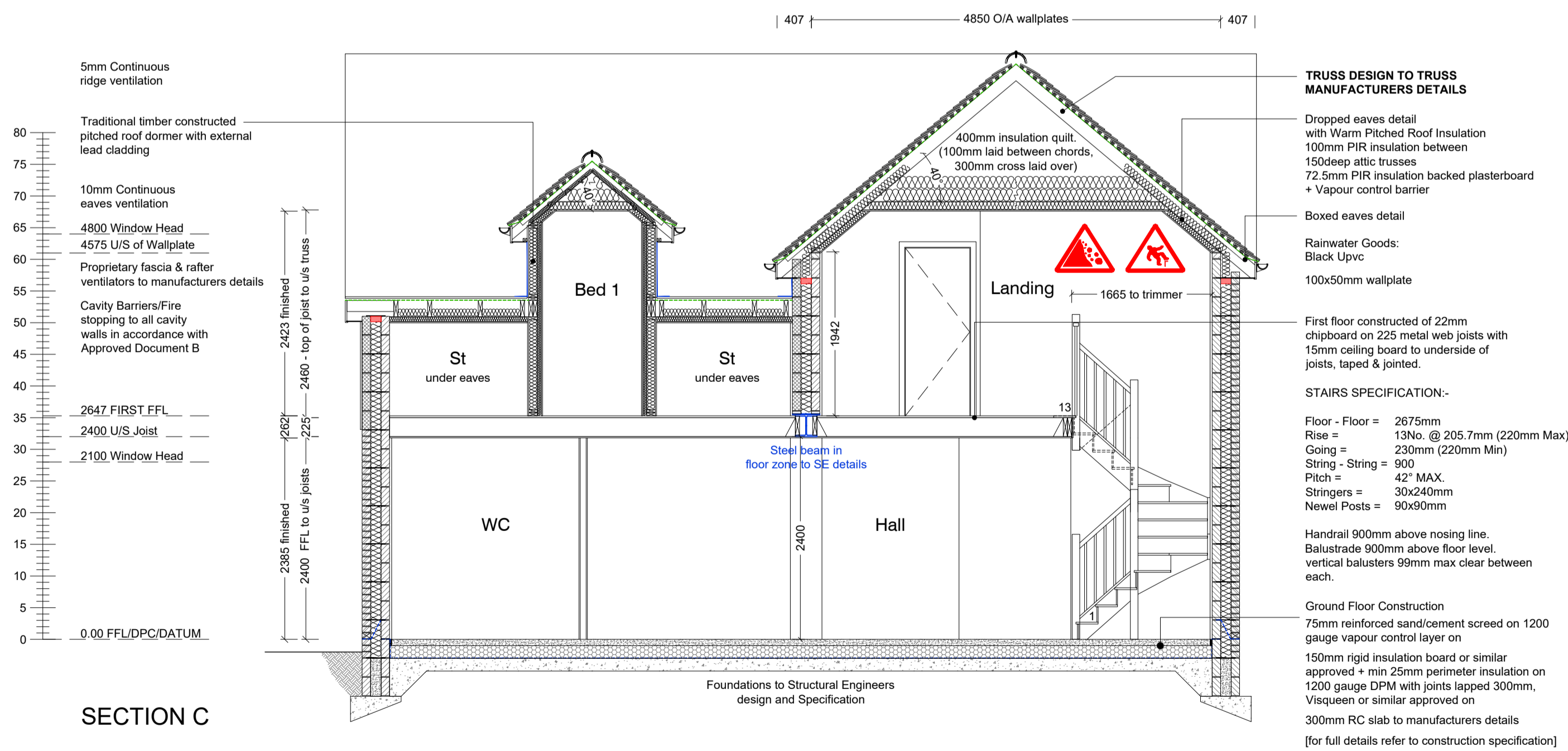

SECTION C

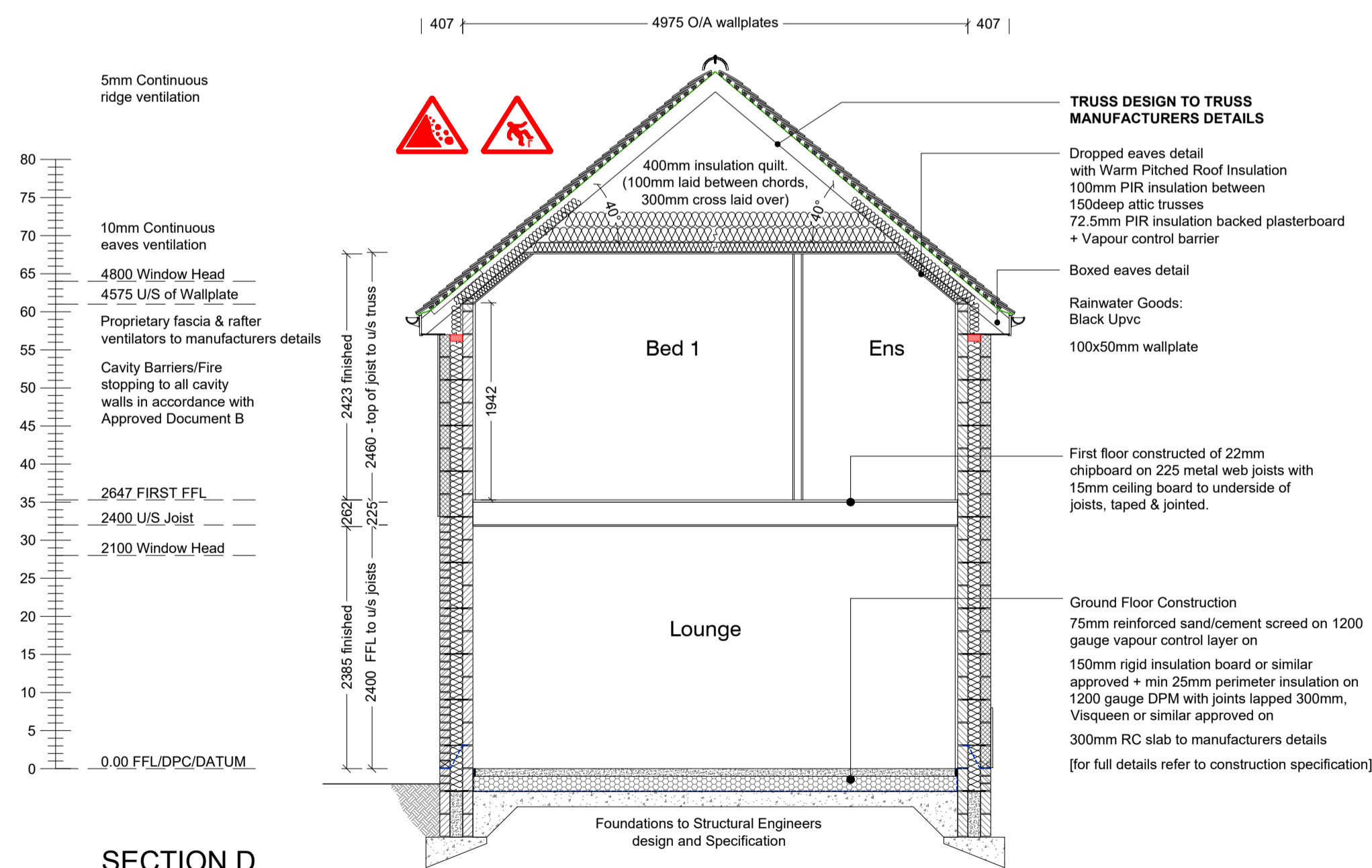

SECTION D

House Type E [3B6P]
Open Market
AS - Plots 8 & 12
OPP - Plots

Total Internal Floor Area:
GIA = 164.1m² / 1766.3ft²
NIA = 161.7m² / 1740.5ft²



ADS ARCHITECTS LIMITED
CHARTERED ARCHITECTS & INTERIOR DESIGNERS

Twyford Lodge, Blayney's Lane
Greenhill, Evesham.
Worcs WR11 4TR

T : 01386 41898
M : 07979 965625
E : franco@adsevesham.co.uk

www.adsevesham.co.uk

PROJECT/CLIENT:

Proposed Development of Land
At 90 Winchcombe Road
Sedgeberrrow
Evesham, WR11 7UB
for: SHEILING HOMES

BUILDING REGULATIONS

House Type E

Sections

SCALE 1:50@A1 DATE 11 2023

DWG 21-16-HT-E-04 A